

"NP" NORMAL WITH FRONT MOUNTED SPRINGS

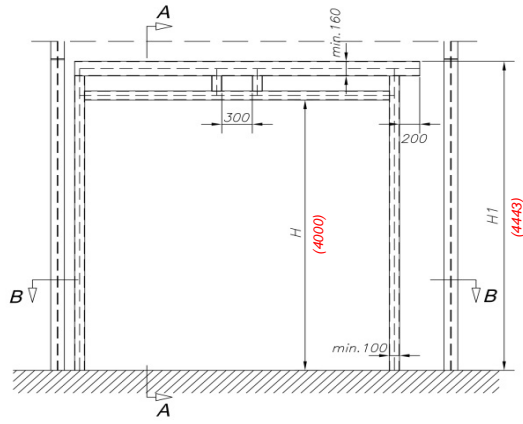

VIEW FROM INSIDE

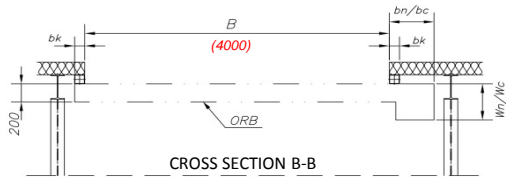

CROSS SECTION B-B

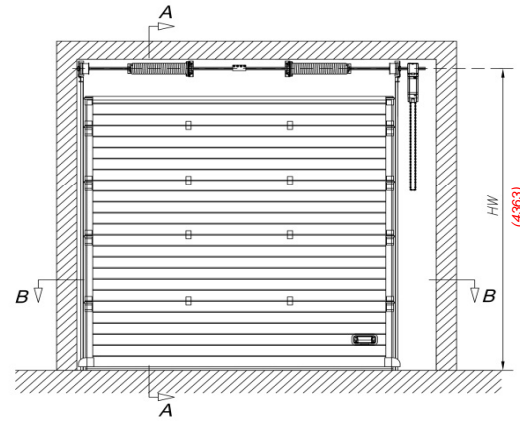

VIEW FROM INSIDE

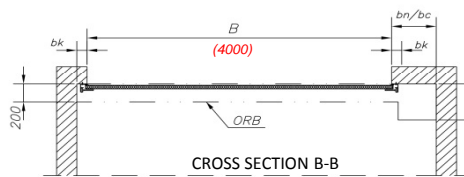

CROSS SECTION B-B

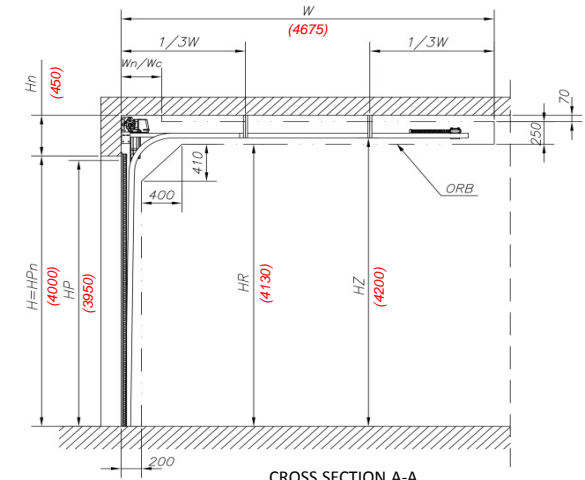

CROSS SECTION A-A

DESCRIPTION OF DIMENSIONS:

- ORB - workspace of the door
- B - opening width
- H - opening height
- Hn - headroom height
- bk - sideroom width with mounting bracket
- b min - sideroom width including perforated angles
- bc - sideroom width on chain mechanism side
- bn - sideroom width on drive side
- HP - passage height in the hand-operated door
- HP+n - passage height in door with drive
- HR - workheight
- HW - height from the floor to axle shaft
- HZ - height from the floor to the bottom edge of horizontal guide
- W - built-in depth (hand-operated door)
- Wn - built-in depth (drive-operated door)
- WC - built-in depth for chain mechanism
- H1 - height from the floor to the upper edge of supporting structure
- Q - curtain's weight [kg/m²]
- P - area of door's curtain [m²]

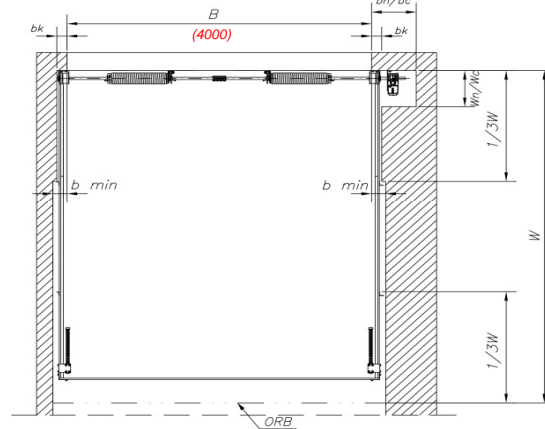

VIEW FROM THE TOP

1. The doors are produced to sizes according to actual pricelist KRISPOL.
2. To adjust the picture to selected size it needs to be accordingly enlarged/reduced.
3. The exact value of Wn by using different types of drives according to actual KRISPOL price
4. Application of the relevant product is a prerequisite for its proper functioning.
5. To select the optimal solution, please contact your representative of Krispol company ---->>> www.krispol.eu

SYMBOL	SIZE LIMIT [mm]			DIMENSIONS ON THE DRAWING [mm]
	B	H	Hn	
B	max.8000			4000
H	max.3000	max.5510	max.6000	4000
Hn	min.450	min.450	min.510	450
HW	H+347	H+363	H+387	4363
H1	H+427	H+443	H+467	4443
bk	min.100			100
b min	min.140			140
bc	min.260			260
bn	min.440			440
HP	H-50			3950
HPn	H			4000
HR	H+130			4130
HZ	H+200			4200
W	H+675			4675
Wn	400			400
Wc	270			270
P Q	K2 IS	P=max.38 [m ²]	Q=max.13 [kg/m ²]	16,00[m ²] 208,0 [kg] 112,0 [kg]
	K2 IM	P=max.38 [m ²]	Q=max.13 [kg/m ²]	
	K2 IP	P=max.31 [m ²]	Q=max.13 [kg/m ²]	
	K2 IA	P=max.32 [m ²]	Q=max.7 [kg/m ²]	

KRISPOL Sp. z o.o.
ul. Budowlana 1
Psary Małe, 62-300 Września

KRISPOL

INDUSTRIAL SECTIONAL DOOR

"NP" NORMAL WITH FRONT MOUNTED SPRINGS

Format	A3	Scale	1:50	Type	K2 I	Drawing No	XYZ_K2IS_NP_4000x4000_2018-8-7
--------	----	-------	------	------	------	------------	--------------------------------